NEWS RELEASE

Green Jade Anniversary | LIFESTYLE 2000 | Advanced CMU Systems

Demonstration

Designed to test and demonstrate a comprehensive menu of state-of-the-art concrete masonry products (EBQ®) capable of producing substantial economies in the cost and time of construction

Products

Based on an auto-inspection design program, the EcoBloQ® interlocking systems include foundations, walls, suspended floors and cladding with integral envelope insulation, all within the UAM™ module compatible with Metric and Imperial dimensions.

Energy

While offering 25% more CO2 capture area and needing 40% less mortar than conventional CMU, EBQ® allows material energy credits with walls that contain factory-installed parallel insulation layers to meet the evolving Energy Code Standards.

For further details refer to:

APPENDIX

EBQ Beauty 2



Sustainable EcoBloQ®

After three and a half decades (1991 - 2026) safely sheltering its original buyers within a structure impervious to fire, earthquake and high winds, the **Lifestyle 2000** house stands today as when new, demonstrating the lasting beauty and sustainability of its innovative, ahead-of-its-time concrete unit systems.

Joint Research

Building of the **Lifestyle 2000** Research Home was co-sponsored by the *National Association of Home Builders* (NAHB) and the *National Concrete Masonry Association* (NCMA), and completed in 1991 at the NAHB Research Park in Bowie, MD USA

Contact for additional information:

RAPIDBUILDING®

P.O. Box 3335

Reston, VA 20195 - USA

Email = sales@rapidbuilding.com

Web = <https://rapidbuilding.com>

THE BEAUTY & SUSTAINABILITY OF ECOBLOQ®

LIFESTYLE 2000 1991 - 2026

GREEN JADE ANNIVERSARY

Demonstration of Advanced Concrete Masonry Systems

Yes, what you are seeing below is a house built with structural/insulated/architectural concrete ecobloQ® interlocking units - no “siding” required on this home. Designed by Jorge Pardo AIA, NCARB to combine conceptions of what an American home could be in the twenty-first century, with the needs of an evolving population, the **Lifestyle 2000** project was completed in 1991 to test and demonstrate a comprehensive menu of state-of-the-art masonry products capable of producing substantial economies in the cost and time of construction.

Building of the **Lifestyle 2000** Research Home was co-sponsored by the *National Association of Home Builders* (NAHB) and the *National Concrete Masonry Association* (NCMA). Completion of the project at the NAHB Research Home Park in Bowie, MD USA resulted in overwhelmingly positive response from the media and from builders worldwide.

After three and a half decades safely sheltering the original family buyers within a structure impervious to fire, earthquake and high winds, and with a minimum expenditure of energy (see Features), the **Lifestyle 2000** house stands today as when new, but for the growing landscaping (see below), demonstrating at this mature stage of performance the lasting beauty and sustainability of its innovative, ahead-of-its-time components (see EBQ® systems).



THE BEAUTY & SUSTAINABILITY OF ECOBLOQ®

Based on the success of the **Lifestyle 2000** project, the concrete systems demonstrated are marketed by [Synthesis International, Inc.](#) (Synthesis) under the **ECOBLOQ®** (EBQ®) and **RAPIDBUILDING®** (RBS) trademarks using the *Universal Architectural Module* (UAM™) developed by Jorge Pardo, AIA to generate compatibility between Imperial and Metric dimensioning systems.

Synthesis offering describes an economical masonry technology that enables significant reductions in the skill and cost of labor through the EBQ® systems, and which is applicable to market segments within every price range as shown by single and multiple dwelling prototype units of proven adaptability to conditions worldwide (See <https://vimeo.com/53128396>).

ENERGY & AIR QUALITY FEATURES

- **Integral Insulation** Factory installed, in Vertical and Horizontal planes
- **Vertical De-stratifier** Automatic air re-circulator
- **Radiant air-core floor** Basement air supply/heat storage BiaxBloQ™
- **Qualitair™ Exchanger** Air intake and discharge heat recovery
- **SpanbloQ™ Floors** Heat distribution and storage
- **Passive solar Aperture** Window area calibrated to thermal mass storage
- **Low-E Glazing** Windows and window-walls
- **Zoned HVAC system** Coupled mass-chargers - De-stratifier
- **Deep Daylighting** Basement TerraLiteWells™ + Clerestories
- **MiniTrombe™** Winter-Summer solar collector/ventilator



THE BEAUTY & SUSTAINABILITY OF ECOBLOQ®

EBQ® SYSTEMS DEMONSTRATED in the Lifestyle 2000

- **FooterBloQ™** Segmental Interlocking footings
- **FormWall™** Concrete snap-on wall forming system (shutterwork)
- **BiaxBloQ™** Air-core service/energy distribution & storage
- **EcoStruct™** Interlocking, Twin-insulated Envelope (Load-bearing)
- **EcoShell™** Insulated architectural cladding
- **Dry-Tensor™** Groutless, post-tensioned wall system
- **SpanBloQ™** Craneless concrete units elevated floor/roof
- **Terrastop™** Mortarless Landscaping wall system

In response to the interest in the **ECOBLOQ®** technology demonstrated by builders and developers in Countries where concrete and masonry are traditional house-building materials, Synthesis has offered **RAPIDBUILDING®** as a comprehensive technology-transfer package including production moulds and equipment, as well as training and technical support services, all based on feasibility studies defining the project costs and ROI of producing and building with EBQ® technology in each particular market.

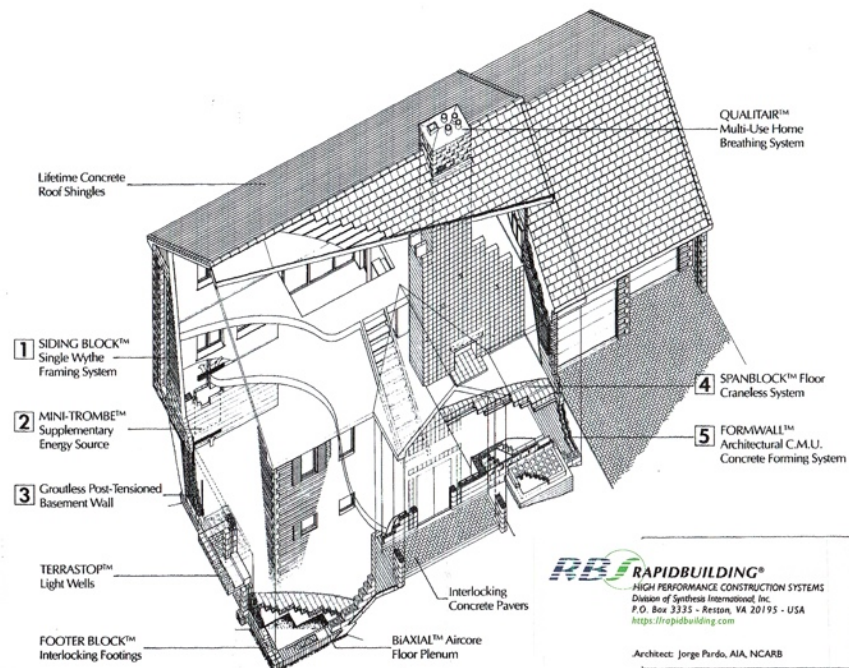

While individual EBQ® systems are successfully used in the USA, international implementation of the holistic RBS™ technology concept, that melds *Product Manufacture* with *Design and Construction (MDC)* activities to attain unmatched building cost efficiency, requires parties with substantial capitalization, able to meet challenging regulations and volatile market conditions. Accordingly, only well qualified, far-sighted licensees may progress to realize construction of RBS™ *Housing Prototypes* designed by Synthesis.

A broad sampling of the unique design models by Synthesis evidences the profitable range of structures that can be built economically with EBQ®, when produced at volumes matching the output capacity of dedicated RBS™ manufacturing plants, and constructed by low-skill labor crews trained by RBS™.

building a new world
rapidbuilding®
P.O. Box 3335 Reston, VA 20195 U.S.A.
<https://rapidbuilding.com>